

mistley

BATHROOM GLASS

Single Bath Screen Installation Instructions

Supplied Parts

Wall to Glass Hinges x2
Screw covers, screws, Rawl plugs and Allen key
Plastic Hinge Seal + Plastic Under-Door Seal
Glass Door
Door Mounting Block x2

Required Tools

Spirit level
Pencil
Drill (with bit & screw-driver fitting to match supplied screws)
Silicone gun
Measuring tape

Glass lifter
Utility knife
Setsquare

Attach both wall hinges to the glass door through the pre-cut holes, using a setsquare to ensure they are horizontal. Tighten using the Allen key, just enough to hold the hinges in position.

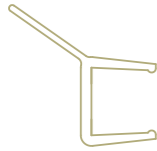

Fit the door to wall seal into place on the glass door.
Trim any excess at the top.

Place the height positioning blocks on the edge of the bath, where the door will hang. Lift the door into position on the blocks.

Use the spirit level to check the square between the bath and the wall. Make sure the glass door is plumb vertical and the hinges are flush with the wall. If necessary, manoeuvre the door horizontally to adjust the gap between it and the wall, then tighten the hinges firmly using the Allen key; mark the screw holes with a pencil.

Remove the glass (complete with hinges); drill the wall holes; insert Rawl plugs.

Replace the glass door on the height positioning blocks, and secure by screwing the hinges to the wall.

Remove the blocks.

Fit the door seal into place on the base of the door with the deflection blade pointing to the inside of the shower.



Fit the screw covers to the hinge screws.

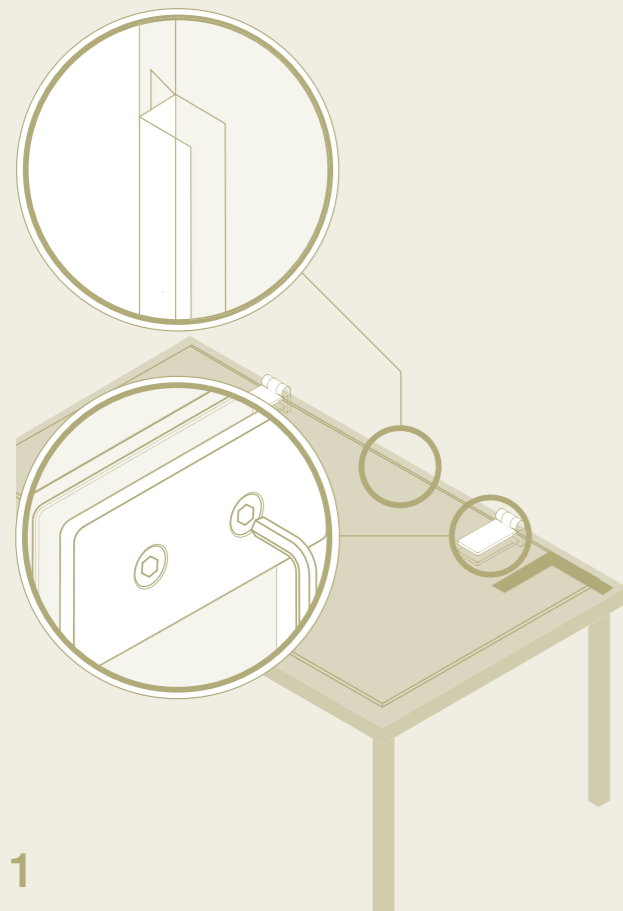

1

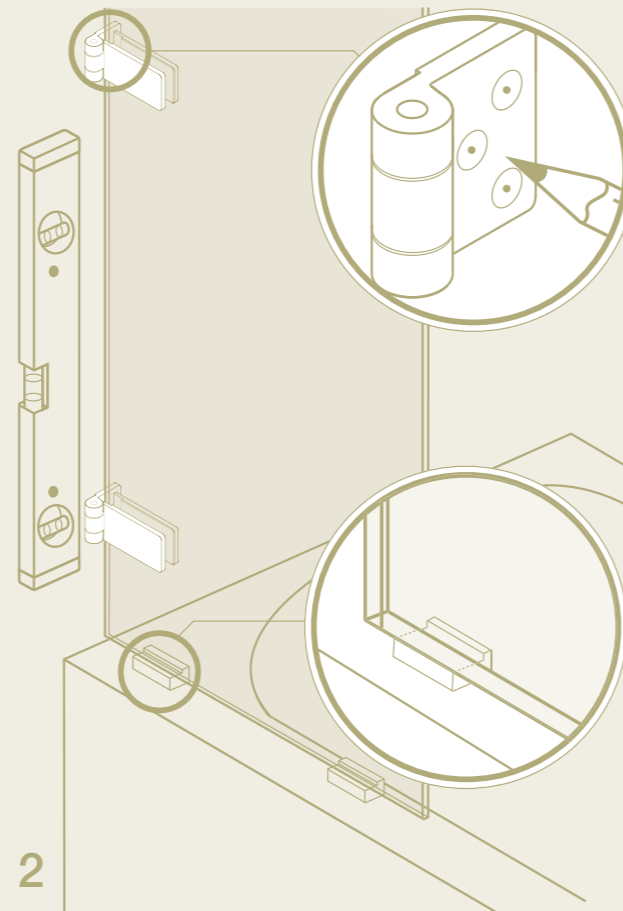

2

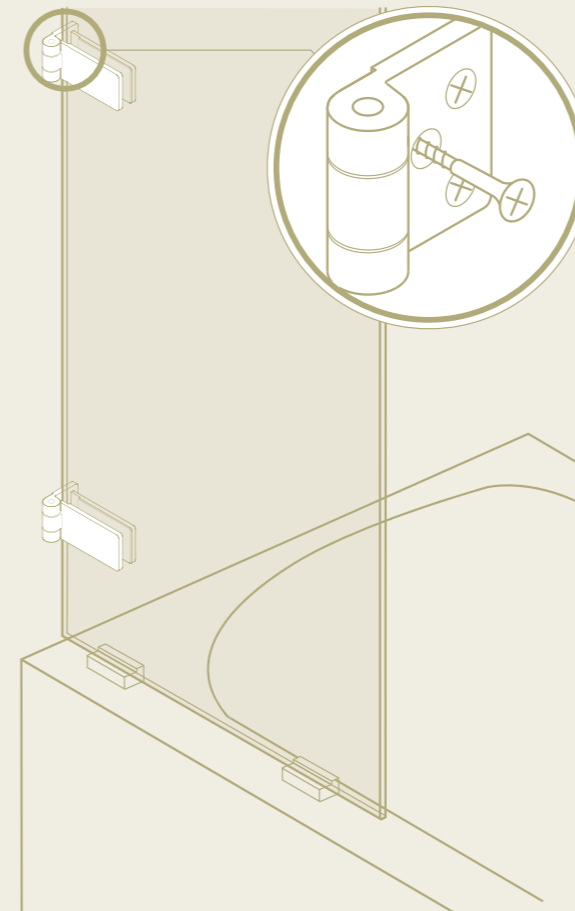

3

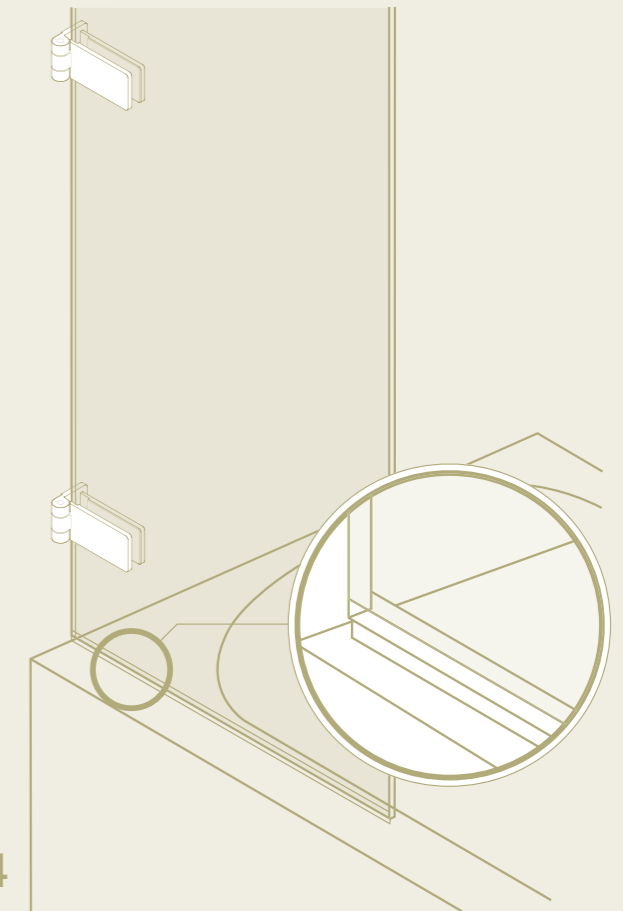

4