

mistley

BATHROOM GLASS

## Fixed Panel Installation Instructions

### Supplied Parts

Vertical channel + screws and Rawl plugs  
Horizontal channel + rubber cushion strip  
Glass panel  
Wall to glass bracket x2 + screws, Rawl plugs & Allen key  
Support arm + grub screws & Allen key  
(supplied with panels of 1000mm or more)

### Required Tools

Spirit level  
Pencil  
Drill (with bit & screw-driver fitting to match supplied screws)  
Sealant gun  
High-quality silicone  
Glass lifters  
Setsquare  
Junior hacksaw  
Masking Tape

Place the horizontal channel on the floor, secure with masking tape and mark its position.

Hold the vertical channel in position with the mitred end pointing downwards, using the 10mm spacer to align it with the horizontal channel.

Use the spirit level to check the vertical channel is plumb vertical, then mark the channel's screw hole positions on the wall with a pencil.

Remove the vertical channel; drill the wall holes and insert Rawl plugs. Screw the vertical channel back onto the wall.

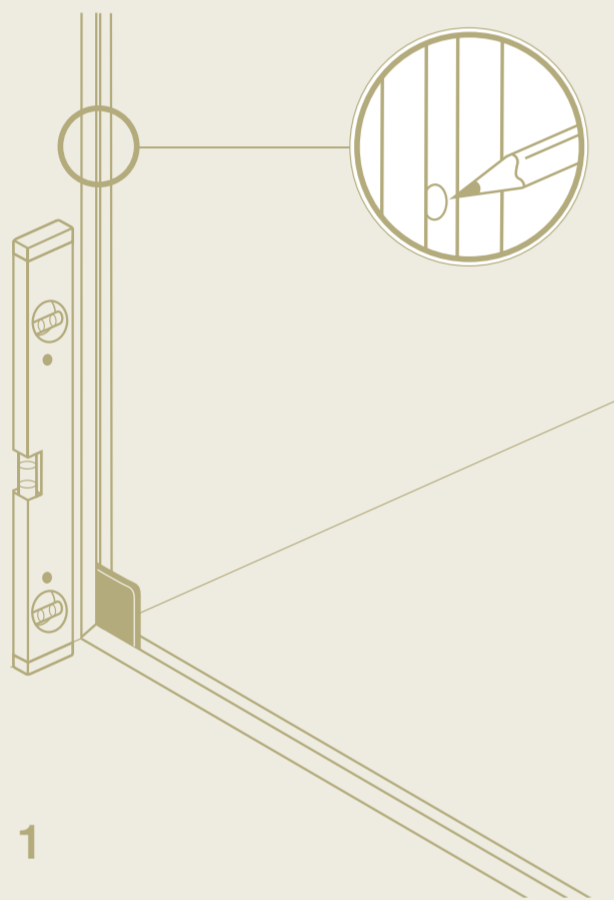

Place the rubber cushion strip into the horizontal channel and fit the glass panel into the channels. Ensure the panel is square and level to the floor (or shower tray).

Attach both wall brackets to the glass through the pre-cut slots, using a setsquare to ensure they are horizontal. Make sure the brackets are flush with the wall; tighten firmly using the Allen key; mark the screw holes with a pencil.

The vertical and horizontal channels may extend beyond the panel; mark the outside edges of the panel on the channels. Remove the glass (complete with brackets) and channels; drill the wall holes and insert Rawl plugs.

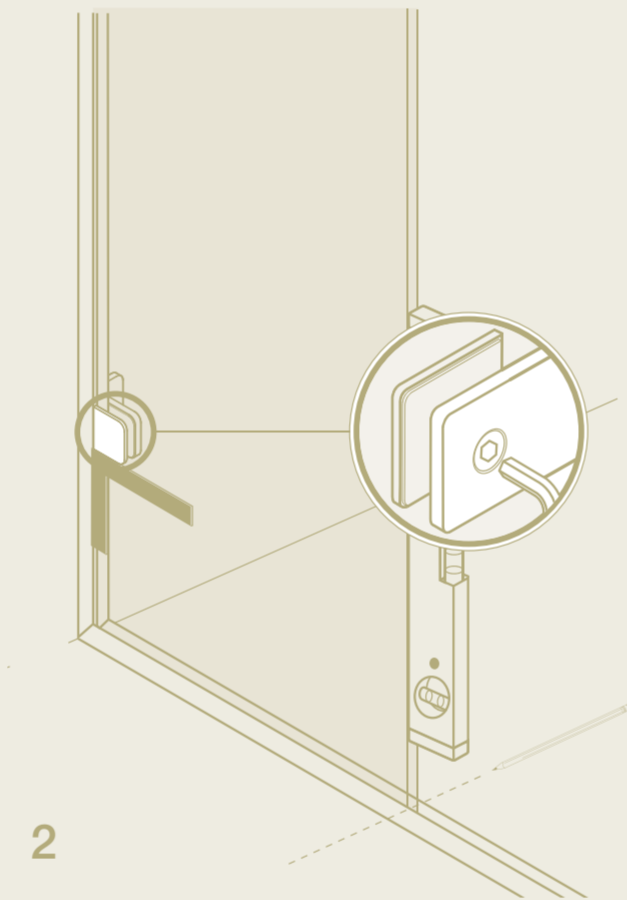

Remove the vertical and horizontal channels.

Using a junior hacksaw, cut away the spare end of the vertical and horizontal channels, and file smooth.

Apply a thin line of silicone that will seal the horizontal channel to the floor, and press into position; re-insert the rubber strip, to cushion the bottom of the glass panel.

Apply a thin line of silicone to the wall-side of the vertical channel, and screw to the wall.

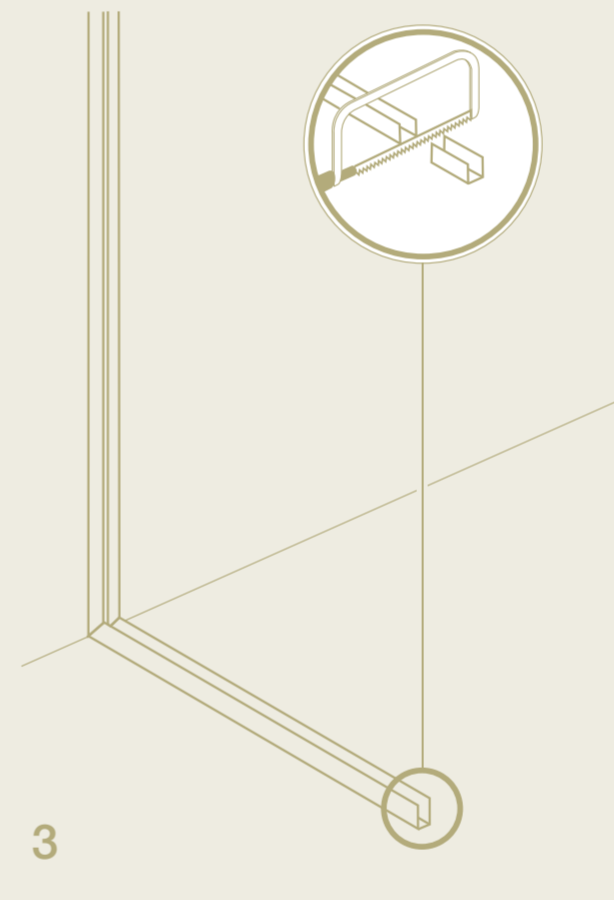

Apply continuous beads of silicone along the inside of the vertical and horizontal channels, and into the corner joint, as shown.

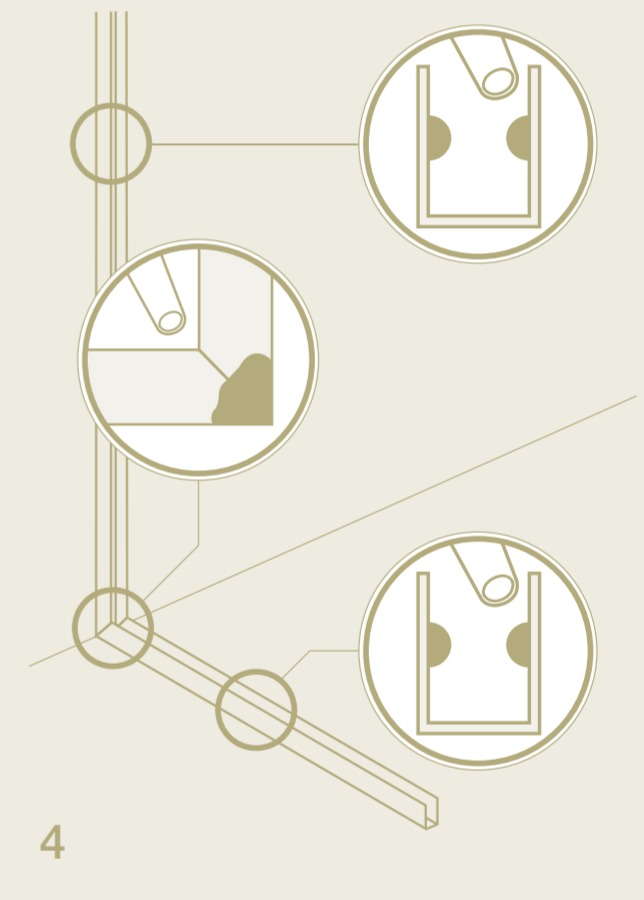

Using the suction glass lifters, carefully re-insert the glass panel into the profiles and secure it by screwing the brackets to the wall.

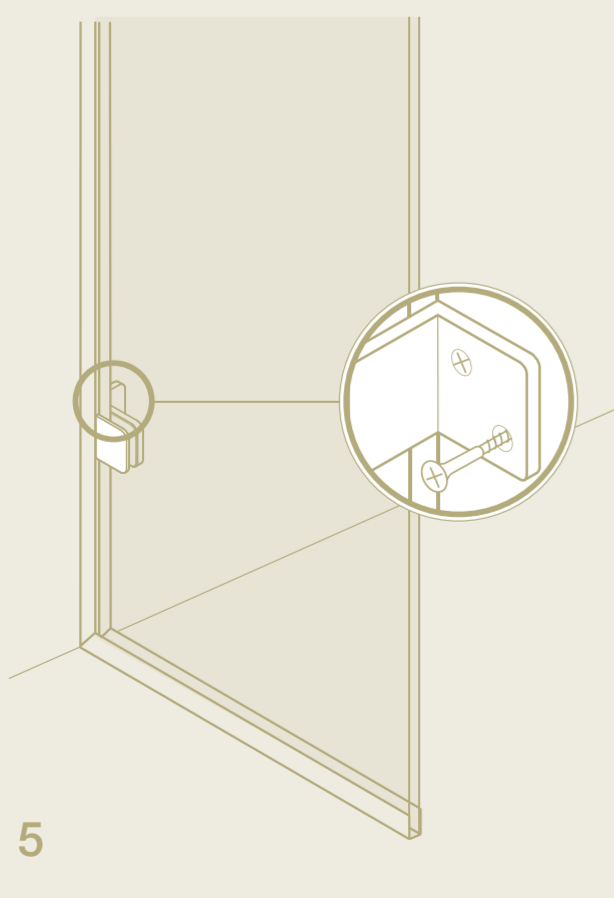

For panels of 1000mm and more a support arm is provided. The support arm must be cut to the correct length: measure the perpendicular distance between the inside edge of the glass and the wall in millimetres, and subtract 35; the result is the required length of the support arm pole.

Using a junior hacksaw, cut away the spare end of the pole and file smooth.

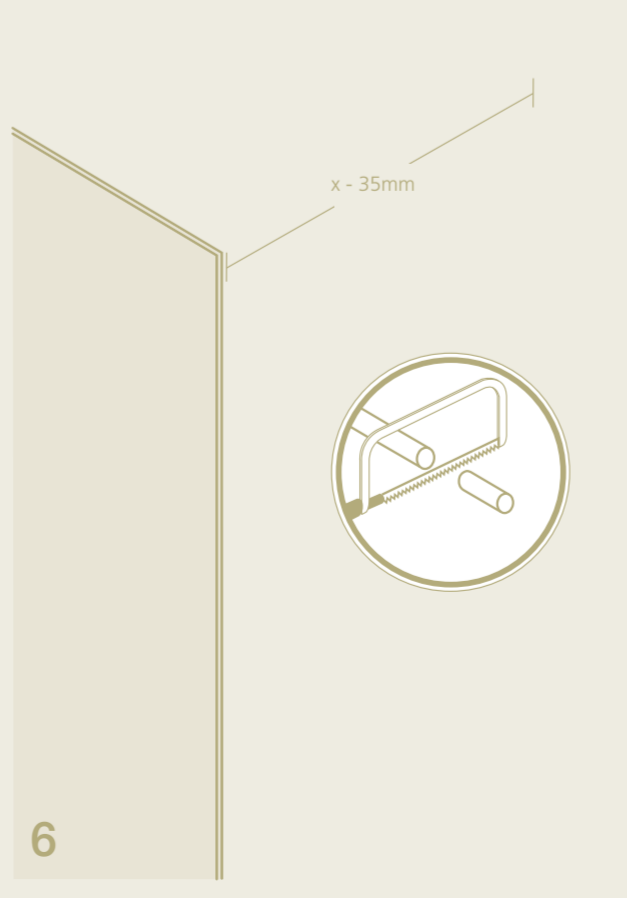

Assemble the support arm and slide it onto the top edge of the glass panel, about 100mm in from the unsupported corner. Using a spirit level to make sure the arm is horizontal, mark the position of the fluted socket on the wall using a pencil.

Drill the wall hole, insert Rawl plug and screw the fluted socket onto the wall. The grub screw hole should be positioned towards the top of the bracket.

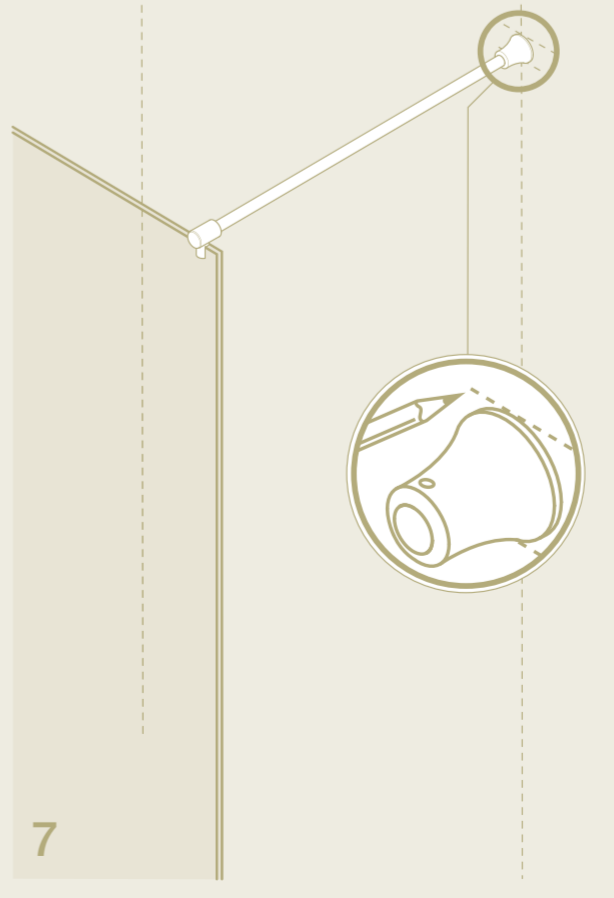

Re-assemble the support arm, and tighten the grub screws on either end. Using the Allen key, tighten the glass bracket. Fit the screw covers to the brackets.

